Maxi Twin Compact

Instructions for Use

ARJOHUNTLEIGH
GETINGE GROUP



WARNING

To avoid injury, always read this Instructions for Use and accompanied documents before using the product.



Mandatory to read the Instructions for Use

Design Policy and Copyright

® and ™ are trademarks belonging to the ArjoHuntleigh group of companies.

© ArjoHuntleigh 2013.

As our policy is one of continuous improvement, we reserve the right to modify designs without prior notice. The content of this publication may not be copied either whole or in part without the consent of ArjoHuntleigh.

Contents

Foreword	4
Intended Use	5
Safety Instructions	6
Preparations	7
Parts Designation	8
Slings	10
Product Description/Function	12
Hand Control	12
Lifting	12
Adjustable Width of Chassis Legs	12
Brakes	13
Driving/Positioning Handles	13
Soft Cover	13
Emergency Stop Button	14
Emergency Lowering Ring	14
Powered Spreader Bar	15
Automatic Safety Stop	15
Battery	16
Battery Indicator Light	16
Battery Charger	16
Attach the Leg Clips (Passive Sling)	17
Straight Leg Attachment	17
Crossed Leg Attachment	17
Transferring the Resident	18
To Lift from a Chair (6 Steps)	19
Return to Chair	20
To Lift from a Bed (10 Steps)	21
Return to Bed	22
To Lift from the Floor (9 Steps)	23
Home Care Use	26
For Distributors and Renters	26
Using Maxi Twin Compact Lift	26
Battery Instructions	28
Cleaning and Disinfecting Instructions	30
Care and Preventative Maintenance	32
Troubleshooting	36
Technical Specifications	38
Dimensions	40
Labels on Maxi Twin Compact Lift	42
List of Standards and Certificates	44
Electromagnetic Compatibility	44
Parts and Accessories	46

Foreword

Thank you for purchasing ArjoHuntleigh equipment.

Your Maxi Twin Compact® mobile passive lift is part of a series of quality products designed especially for hospitals, nursing homes and other health care use. We are dedicated to serving your needs and providing the best products available along with training that will bring your staff maximum benefit from every ArjoHuntleigh product.

Please contact us if you have any questions about the operation or maintenance of your ArjoHuntleigh equipment.

Please Read this *Instructions for Use* thoroughly!

Please read this *Instructions for Use (IFU)* in its entirety before using the *Maxi Twin Compact* lift. Information in the *IFU* is crucial to the proper operation and maintenance of the equipment, and will help protect your product and make sure that the equipment performs to your satisfaction. Some of the information in this *IFU* is important for your safety and must be read and understood to help prevent possible injury.

Unauthorized modifications on any ArjoHuntleigh equipment may affect its safety. ArjoHuntleigh will not be held responsible for any accidents, incidents or lack of performance that occur as a result of any unauthorized modification to its products.

Report Unexpected Operations or Events

Contact your local ArjoHuntleigh representative if any unexpected operations or events occur. The contact information appear on the last page of this *IFU*.

Service and Support

A service routine must be performed on the *Maxi Twin Compact* lift every year by ArjoHuntleigh authorized service personnel to make sure the safety and daily operation of your product. See section *Care and Preventative Maintenance* on page 32.

If you require further information, please contact your local ArjoHuntleigh representative who can offer comprehensive support and service programs to maximize the long-term safety, reliability and value of the product. Contact your local ArjoHuntleigh representative for replacement parts.

Your service representative stocks the parts you will need.

The contact information appears on the last page of this *IFU*.

Definitions in this *IFU*

WARNING

Means: Safety warning. Failure to understand and obey this warning may result in injury to you or to others.

CAUTION

Means: Failure to follow these instructions may cause damage to all or parts of the system.

NOTE

Means: This is important information for the correct use of this system or equipment.



Means: The name and address of the manufacturer.

Intended Use

This equipment must be used in accordance with these safety instructions. Anyone using the equipment must also have read and understood the instructions in this *Instructions for Use (IFU)*.

If there is anything you are not sure about, contact your ArjoHuntleigh representative.

The *Maxi Twin Compact* lift is a floor based sling lift.

The lift is intended to be used for lifting and transfers in hospitals, nursing homes, private homes and in home care of residents. The equipment is intended for indoor use.

The *Maxi Twin Compact* lift is intended to be used for residents who:

- sits in a wheelchair
- has no capacity to support himself/herself
- cannot stand unsupported and is not able to bear weight, not even partially
- is dependent on the caregiver in most situations

or, for a resident who:

- is passive
- might be almost and/or completely bedridden
- is often stiff or have contracted joints
- is totally dependent on the caregiver

The transfer with the *Maxi Twin Compact* lift takes place indoors in the resident room, common areas or in a bathroom, it's not intended to be used in the shower or outdoors.

The *Maxi Twin Compact* lift is only to be used with ArjoHuntleigh-supplied slings that are designed to be used with the *Maxi Twin Compact* lift.

The *Maxi Twin Compact* lift should only be used for the purpose specified in the *Instructions for Use (IFU)*. Any other use is prohibited.

Resident Assessment

We recommend that facilities establish regular assessment routines. Caregivers should assess each resident according to the following criteria prior to use:

- The residents weight must not exceed 160 kg, (350 lbs).
- The product should not be used for residents who suffer from uncontrollable head movements.

If the resident does not meet these criteria an alternative equipment/system shall be used.

Indication for Use

A non-AC-powered patient lift is a hydraulic, battery, or mechanically powered device, either fixed or mobile, used to lift and transport a patient in the horizontal or other required position from one place to another, as from a bed to a bath. The device includes straps and a sling to support the patient.

Installation and Service Requirements

The expected lifetime of this equipment, unless otherwise stated, is ten (10) years, subject to preventive maintenance being carried out in accordance with the instructions for care and maintenance found in the *Instructions for Use (IFU)*.

Depending on level of wear some equipment parts such as castors and hand control may need to be replaced during the equipment life time according to information in the *Instructions for use (IFU)*.

Safety Instructions

WARNING

To avoid injury to both the patient and the caregiver, never modify the equipment or use incompatible parts.

WARNING

To avoid injury, make sure there is a safe distance between the resident and the device. Pay particular attention to resident with uncontrollable movements.

WARNING

To avoid falling, make sure that the user weight is lower than the safe working load for all products or accessories being used.

WARNING

To avoid injury, only use ArjoHuntleigh slings specified in these *Instructions for Use*. To select correct sling size follow the specific sling *Instructions for Use*.

WARNING

To avoid entrapment, make sure to keep the residents hair, arms and feet close to the body and use designated grab supports during any movement.

WARNING

To avoid the resident from falling, always make sure that the device is in the lowest possible position before attempting to transfer, dress or undress the resident.

WARNING

To avoid entrapment of the residents or caregivers legs or feet, make sure that they are kept clear of all obstacles.

WARNING

To avoid explosion or fire, never use the equipment in oxygen rich environment, in presence of heat source or flammable anaesthetic gases.

WARNING

To avoid injury, make sure that the resident is not left unattended at any time.

WARNING

To avoid the device from tipping and the resident from falling, do not use the equipment on floor with recessed drains, holes or slopes exceeding a ratio of 1:50 (1.15°).

WARNING

To avoid falling during transfer, always make sure that the brakes are applied on all equipment being used.

WARNING

Do not leave/use the *Maxi Twin Compact* lift and accessories for extended periods in humid, wet areas or in the shower.

Do not use the *Maxi Twin Compact* lift or accessories in the shower.

Preparations

Actions Before the First Use (9 Steps)

- 1 Visually check the package for damage. If the product looks damaged make a complaint to the transport agency.
- 2 Remove packaging by doing following:
 - Cut the two securing plastic bands.
 - Lift off the cardboard cover.
 - Remove the plastic packaging.
 - Remove the cardboard around the legs of the lift.
 - Carefully remove the lift away from the pallet.
- 3 The packaging should be recycled according to local regulations.
- 4 Check that all parts of the product are supplied. Compare with the product description in this *IFU*. If any part is missing or damaged - do not use the product!
- 5 Unpack the battery charger. Select and attach the adapter correctly suited to your power outlet. See *Battery charger IFU*.
- 6 Let the battery charge for 24 hours.
- 7 Disinfect the product according to section *Cleaning and Disinfecting Instructions on page 30*.
- 8 Prepare an area that is dry, with good ventilation and out of direct sunlight for storage of the *Maxi Twin Compact* lift.
- 9 Choose a designated area, where the *IFU* should be kept and is accessible at all times for the users.

NOTE

If you have any questions, please contact your local ArjoHuntleigh representative for support and service. The contact information (*ArjoHuntleigh addresses*) is listed on the last page of this *IFU*.

Actions Before Every Use (4 Steps)

- 1 Check that all parts of the lift are in place. Compare to *Part Designations* page.
- 2 Pre-inspect the sling prior to use. If any part is missing or damaged - do NOT use the product.
- 3 **WARNING**
To prevent cross-contamination, always follow the disinfection instructions in this *Instructions for Use*.
- 4 A resident prone to kicking must have the leg clips of the sling crossed. This prevents the resident from falling as a result of clip detachment due to kicking. See section *Attach the Leg Clips (Passive Sling)* on page 17.

Maxi Twin Compact lift directions

The direction of driving during transfer is according to the illustration below.

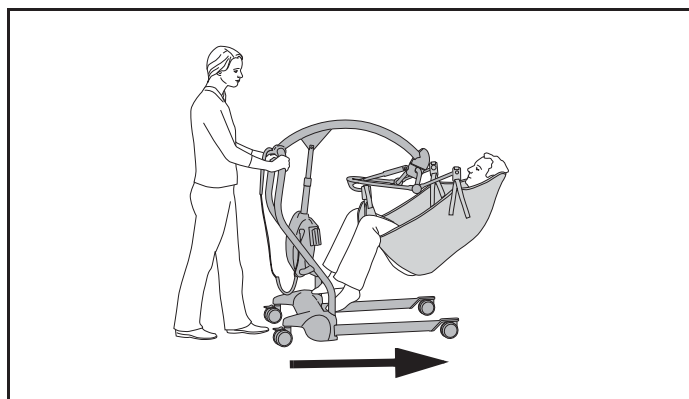

The directions left or right on the *Maxi Twin Compact* lift are given as shown in the illustration.

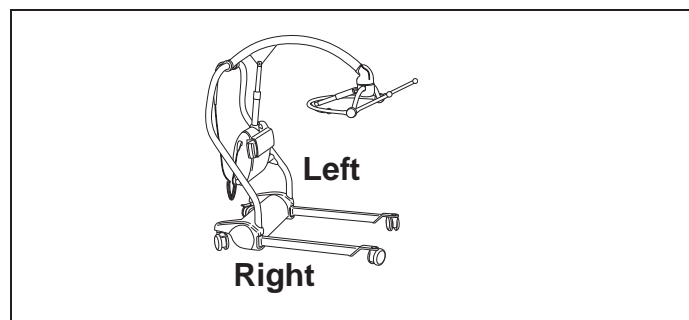

Parts Designation

- | | |
|---------------------------------|--------------------------|
| 1 Mast | 14 Emergency lowering |
| 2 Jib | 15 Emergency stop button |
| 3 Adjustable legs | 16 Battery (charging) |
| 4 Castors (rear) | 17 Battery holder |
| 5 Non-breakable castors (front) | 18 Battery charger |
| 6 Spreader bar | |
| 7 Soft cover | |
| Soft cover, red (accessory) | |
| 8 Hand control | |
| 9 Hand control hang point | |
| 10 Battery | |
| 11 Lift actuator | |
| 12 Actuator - spreader bar | |
| 13 Driving/positioning handles | |



Entire Product:
Type BF
Applied part: protection against
electrical shock in accordance with
EN 60601-1.

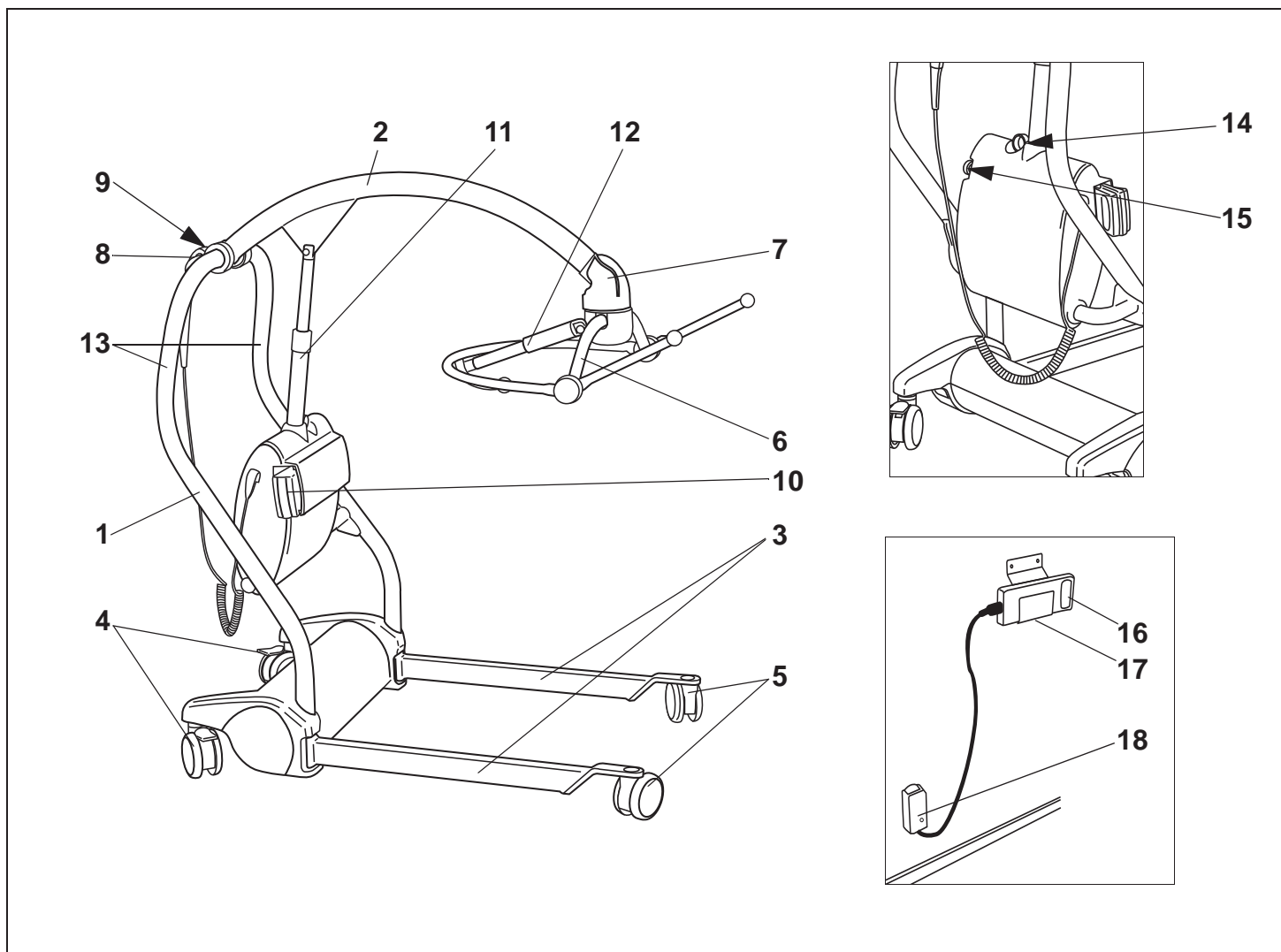

Intentionally left blank

Slings

A label is fitted to the hanger frame for quick colour to size reference See section *Labels on Maxi Twin Compact Lift on page 42*.

Refer to the *Passive Clip Sling IFU* when the size of sling should be chosen.

All ArjoHuntleigh slings are coded for size by having different coloured edge binding as follows:

- Red - Small - S
- Yellow - Medium - M
- Green - Large - L
- Purple - Large Large - LL

Make sure never exceed the **safe working load of the sling or the lift**. The lowest value should always be valid.

WARNING

To avoid injury, only use ArjoHuntleigh slings specified in these *Instructions for Use*. To select correct sling size follow the specific sling *Instructions for Use*.

NOTE

If ArjoHuntleigh Slings are to be used with the *Maxi Twin Compact* lift, then always refer to their instructions before use.

ArjoHuntleigh slings with head support have two pockets at the head section which contain plastic reinforcement pieces during use. Always make sure these reinforcement pieces have been inserted into the sling pockets before using the sling.

Sling Profiles that can be used with Maxi Twin Compact lift

Size: S - LL

**Four point toileting sling
(with head support)**

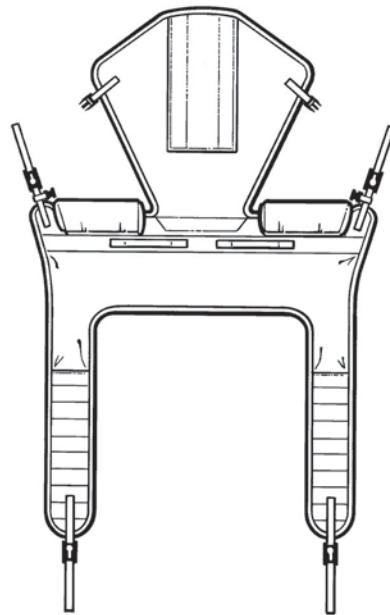

Four point amputee sling

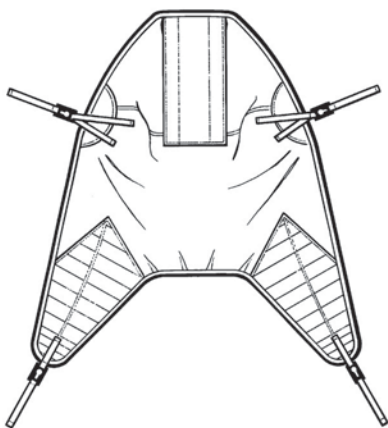
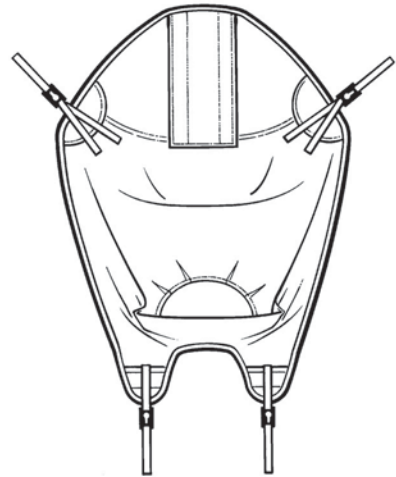

Four point padded sling

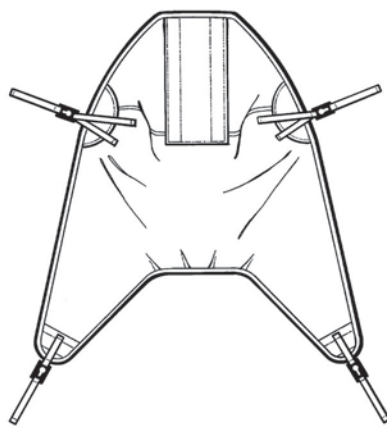

Four point unpadded sling

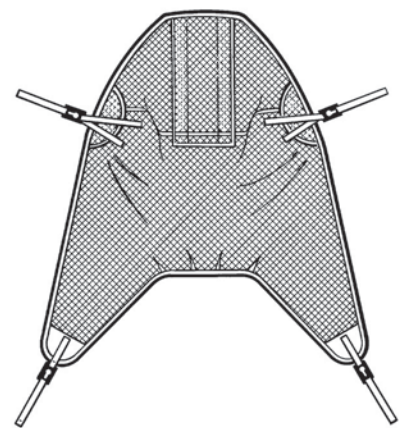

Four point mesh sling

Product Description/Function

Fig. 1

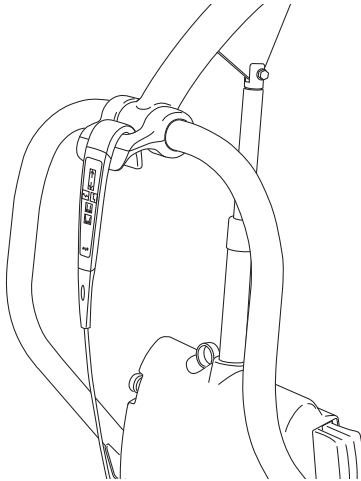

Hand Control

CAUTION

Do not drop the hand control into water.

The hand control has an integrated hook which makes it easy to attach. When not in use, the hand control can be conveniently kept ready for use by hooking it over the hand control hang point at the top of the mast. (See Fig. 1)

Unhook the hand control and hold it in your hand (See Fig. 2):

- Press (A) button in order to raise the jib.
- Press (B) button in order to lower the jib.
- Press (C) button for reclined position.
- Press (D) button for sitting position.
- Press (E) button for **leg close** of chassis.
- Press (F) button for **leg open** of chassis.

Fig. 2

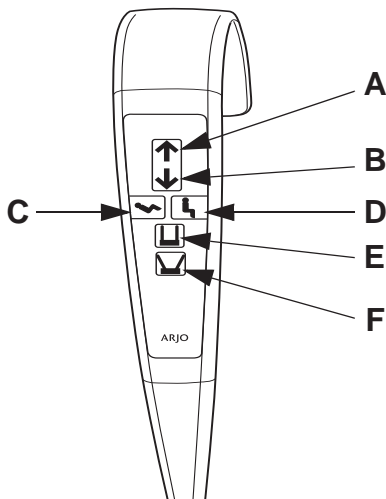

Lifting

The lifting/lowering movement is performed by an actuator driven by an electric motor.

Fig. 3

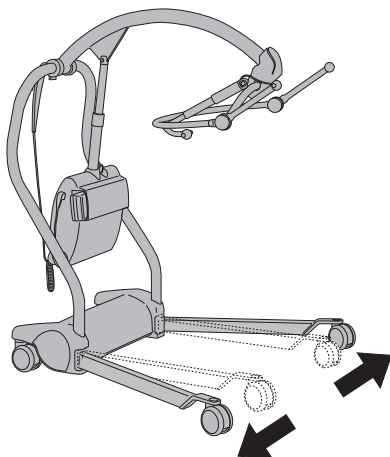

Adjustable Width of Chassis Legs

The chassis legs can be opened to variable widths.

Select the “Open chassis legs” button on the hand control and keep pressing it until the required width is achieved.

To close, press the “Close chassis legs” button. When pressure is released from the button, movement will stop and the chassis legs will remain securely in position. (See Fig. 3)

NOTE

When opening or closing the legs of the powered chassis, make sure that no one stands in the way of the moving chassis legs.

Fig. 1

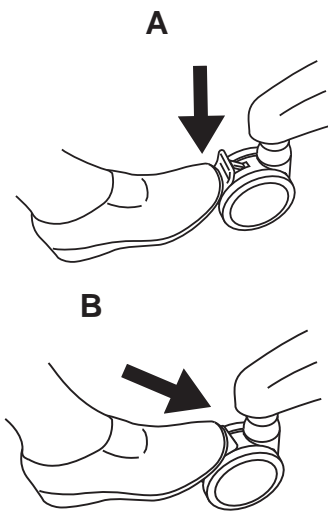

Brakes

The chassis rear castors have brakes which can be foot operated to keep the *Maxi Twin Compact* lift in position. Brake (A) and release the brake (B). The brakes on both castors have to be applied to get full effect. (See Fig. 1)

Fig. 2

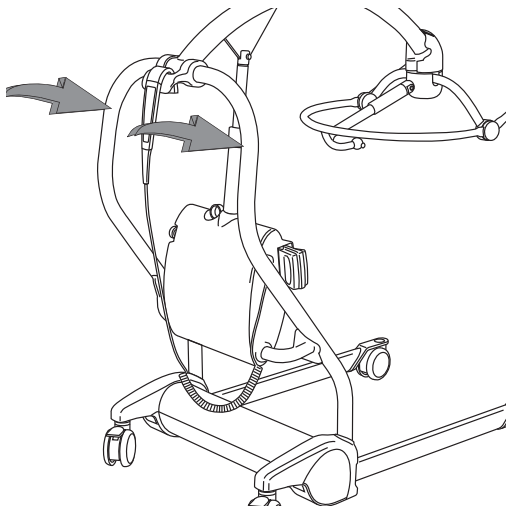

Driving/Positioning Handles

Use the driving handles when pushing and positioning the *Maxi Twin Compact* lift. (See Fig. 2)

Fig. 3

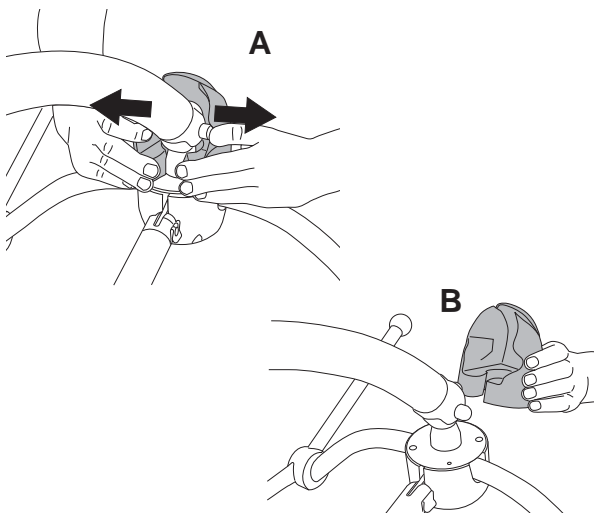

Soft Cover

Placed on the end of the jib to protect the resident from being hurt. The upper part of the cover can be removed to facilitate cleaning. (See Fig. 3; A and B)

The cover can also be removed and changed to a red colour (accessory). The deep red colour helps when transferring a resident with dementia as the colour makes it easier for the resident to be aware of the jib and so reduce any risk of an impact. (See Fig. 3)

Fig. 1

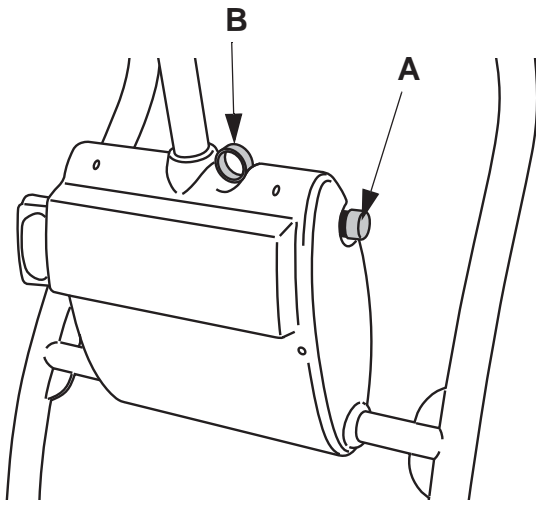

Emergency Stop Button

If, in an emergency, you have to immediately stop any powered movement, (other than by releasing pressure on the hand control button), press the emergency stop button (A).

(See Fig. 1)

Once the emergency stop button has been operated, it will have to be reset before any powered movement can be utilised.

To reset the emergency stop function, turn the red emergency button 1/8 of a turn clockwise until it pops up.

Emergency Lowering Ring

WARNING

To avoid injury, only use the emergency lowering when normal lowering is impossible. Use extreme care during lowering.

It is necessary to pull the ring (B) slowly and carefully to get a controlled lowering of a heavy resident. If not, the lowering might be too fast.

This can be used in the event of main control failure. Emergency Lowering control (B), situated on the top of the main lift actuator housing, a green and white identification label is positioned near the control. Pull the control up to operate, release the control during use and lowering will stop.

(See Fig. 1)

NOTE

Due to internal friction, the speed of lowering will vary depending on the weight of the resident. You may have to assist the downwards movement by pulling down the jib.

Fig. 1

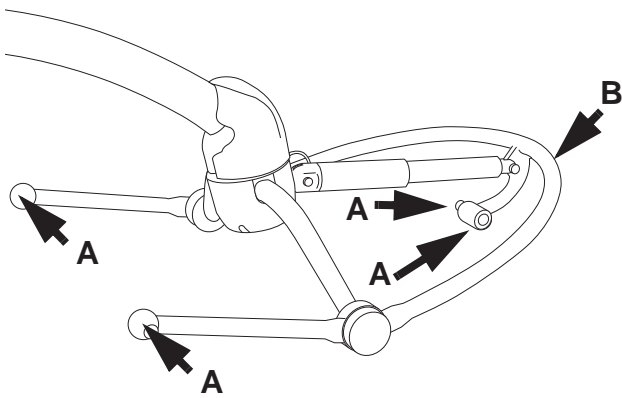

Powered Spreader Bar

Four knobs (A) enable the sling clips to be attached.

Adjustment by hand of the position of the resident sideways is possible when using the spreader bar frame (B).

The spreader bar is operated from the hand control and moves the resident to reclined or sitting position. (See Fig. 1)

CAUTION

Do not immerse the spreader bar under water, it can damage the positioning system.

Automatic Safety Stop

This is not operator controlled but a function built into the electronics of the lift.

Function I:

If the lift is moving up /down and it moves against something, the movement will be stopped by an automatic safety stop. Release the up /down button on the hand control.

Function II:

If the lift is mistakenly overloaded with a resident heavier than permitted, an automatic safety stop will automatically be activated. If this occurs, stop pressing the up button on the hand control. Lower the resident by pressing the down button and then remove the resident from the lift.

Fig. 1

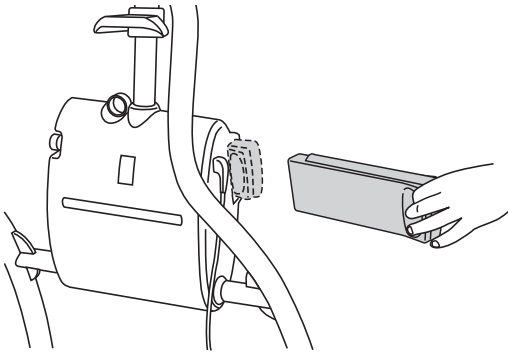

Battery

The battery is situated on the side of the lift actuator housing.
(See Fig. 1)

NOTE

The battery shape only fits correctly into the lift with its raised edge upwards.

Battery Indicator Light

A beeping sound and a low battery indicator (A) light will flash when the battery needs charging. The function in progress will be able to be finished. (See Fig. 1)

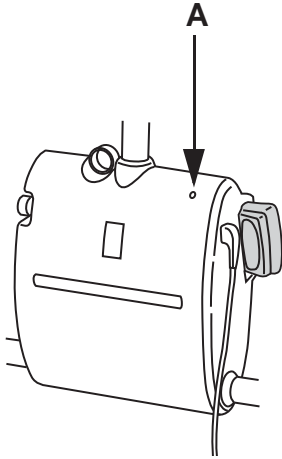
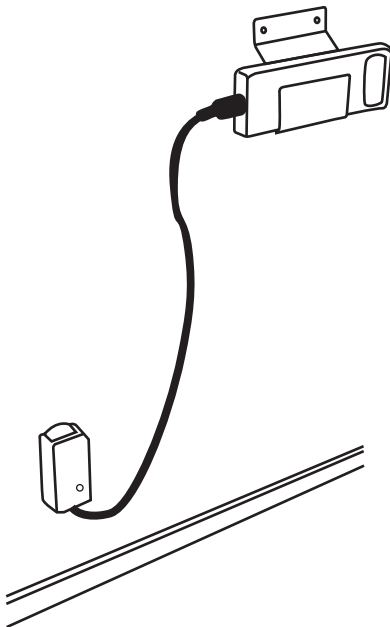

Fig. 2



Battery Charger

See Battery charger *IFU*. (See Fig. 2)

Type no:

NEA 8000

Attach the Leg Clips (Passive Sling)

Fig. 1

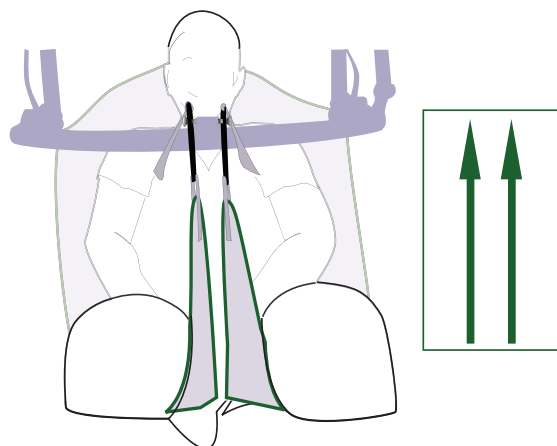

Straight Leg Attachment

For most residents, it is recommended to use the straight attachment of the leg clips. (See Fig. 1)

Attach the leg clips to the lugs so that the leg straps are positioned vertically.

Fig. 2

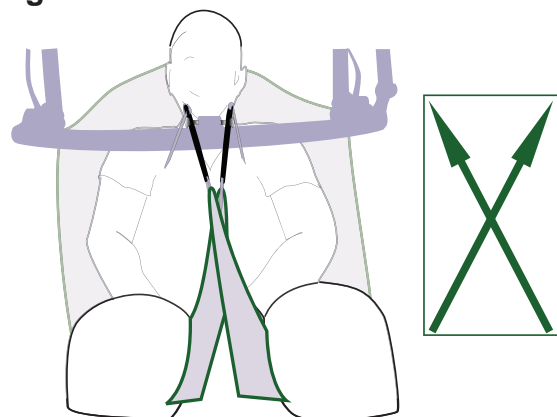

Crossed Leg Attachment

If the resident is prone to kicking, the crossed leg attachment of the clips must be applied. This prohibits the leg clips from detachment due to kicking and prevents the resident from possible injury. (See Fig. 2)

Cross the leg straps of the sling and attach the clips to the lugs.

Transferring the Resident

Before the Resident is Transferred onto the *Maxi Twin Compact* lift, make sure that:

- the battery pack is fully charged before use (for charging, see *Battery IFU*) and remove it from the charger unit and insert it into the battery position of the *Maxi Twin Compact* lift. Electrical connection will be made automatically.
- a selection of sling types and sizes are easily available for all types of lifting procedure when using the *Maxi Twin Compact* lift.
- where possible, approach the resident from the front.
- if required, the chassis legs can be opened to go around a chair or wheelchair

WARNING

To avoid injury, make sure that the resident is not left unattended at any time.

WARNING

To avoid entrapment, make sure the path of the movement is free from obstacles.

Fig. 1

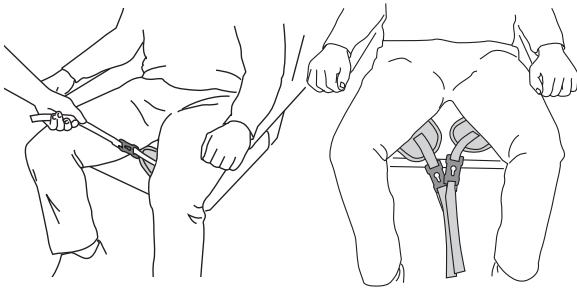

Fig. 2

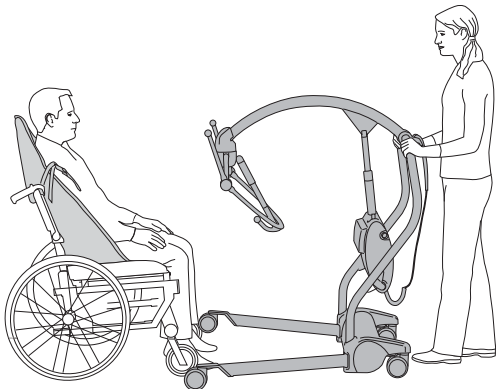

Fig. 3

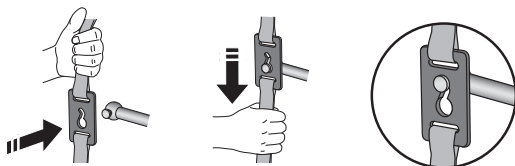
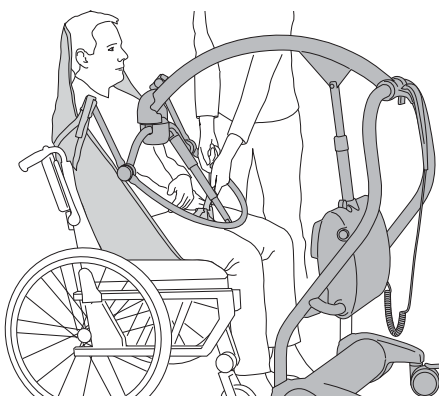

Fig. 4



To Lift from a Chair (6 Steps)

1

WARNING

To avoid injury, make sure there is a safe distance between the resident and the device. Pay particular attention to resident with uncontrollable movements.

Place the sling around the resident so that the base of his/her spine is covered, and the head support area is behind the head. Pull each leg piece under the thigh so that it emerges and does not remain folded. (See Fig. 1)

2

Place the *Maxi Twin Compact* lift close enough to be able to attach the shoulder clips of the sling to the spreader bar. To accomplish this you may have to put the resident's feet on, or over the chassis. (See Fig. 2).

3

WARNING

To avoid entrapment, make sure to keep the residents hair, arms and feet close to the body and use designated grab supports during any movement.

NOTE

Do not apply the castor brakes at this stage, as the position of the resident will adjust to his/her own centre of gravity when lifted.

With the *Maxi Twin Compact* lift in position, first attach the shoulder clips to the lugs on the spreader bar and then attach the leg clips). (See Fig. 3)

4

Lower the spreader bar using the hand control, be careful not to lower it onto the resident. If the spreader bar is lowered too close against the thigh of the resident a beep sound will be heard and the powered motion will stop immediately. (See Fig. 4)

Continue with the steps on the next page.

Fig. 5

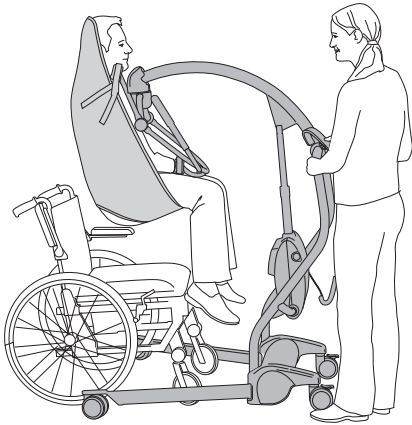

5 **WARNING**

To avoid the resident falling, make sure that sling clips or loops are securely attached before as well as during the lifting initiation.

Raise the resident by operating the hand control, move the lift away from the chair. (See Fig. 5)

- 6 Adjust the angle of recline to a comfortable position and a height a little higher than normal chair height. Turn the resident to face the caregiver before the transfer. Make sure that her/his feet are safely above the floor. (See Fig. 6)

Fig. 6



Fig. 7

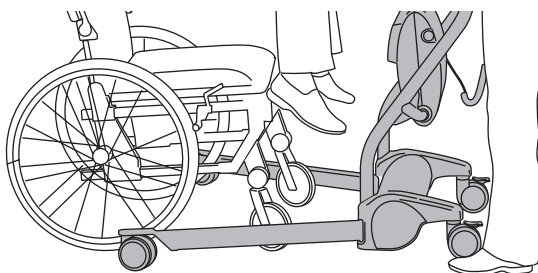

Return to Chair

When returning to a chair, make sure the lift legs are positioned around the legs/wheels of the chair. (See Fig. 7)

To position the resident over the chair, use the lift handles, do NOT pull the sling.

The resident suspended in sling should always remain in the centre of gravity. (See Fig. 5)

Use the hand control to lower the resident.

When lowering the resident back into a chair - or when transferring from bed to chair:

- Position the resident via the hand control to maximum sitting position.
- Lower the resident onto the chair. Make sure that the resident is positioned well back in the chair.

To Lift from a Bed (10 Steps)

Before lifting a person from a bed, make sure there is sufficient clearance underneath to accommodate the *Maxi Twin Compact* lift chassis legs.

It is possible via the hand control to adjust chassis leg widths to assist manoeuvrability around obstructions, for example, bed legs.

Fig. 1

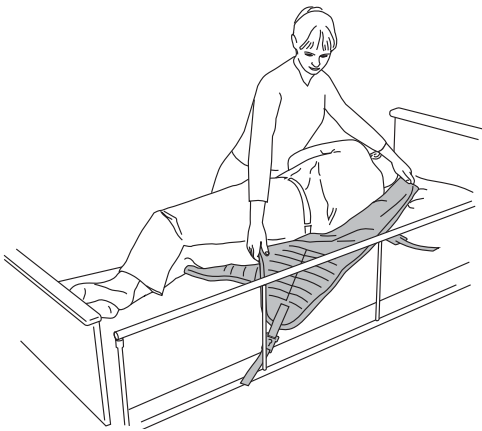

1 **NOTE**

When rolling the resident back onto the sling, roll the resident slightly in the opposite direction so that the folded part of the sling can be brought out.

Position the resident onto the sling by rolling the resident towards you then folding the sling in half and placing it behind the resident's back. This is also called the log roll method. (See Fig. 1)

- 2 Position the sling carefully so that when rolled back, the resident is centred on the sling and check that the head support area of the sling covers the resident's neck. (See Fig. 2)

Alternatively, the resident can be brought into a sitting position then place the sling as detailed in the section "To Lift From A Chair".

3 **WARNING**

To avoid injury to the resident, pay close attention when lowering or adjusting the spreader bar.

Approach the bed with the open side of the spreader bar towards the resident's head. (See Fig. 3)

- 4 Position the *Maxi Twin Compact* lift so that the spreader bar is just above, and centred over the resident. (See Fig. 3)
- 5 If possible, slightly raise the head part of the bed to make the fastening of attachment clips easier. (See Fig. 3)
- 6 Tilt the spreader bar until the shoulder attachment points can be connected to the sling shoulder clips. (See Fig. 3)
- 7 Connect the sling leg pieces. Pull each leg piece under the thigh so that it emerges and does not remain folded. You may need to lower the spreader bar a little more, using the hand control. (See Fig. 3)

Fig. 2



Fig. 3

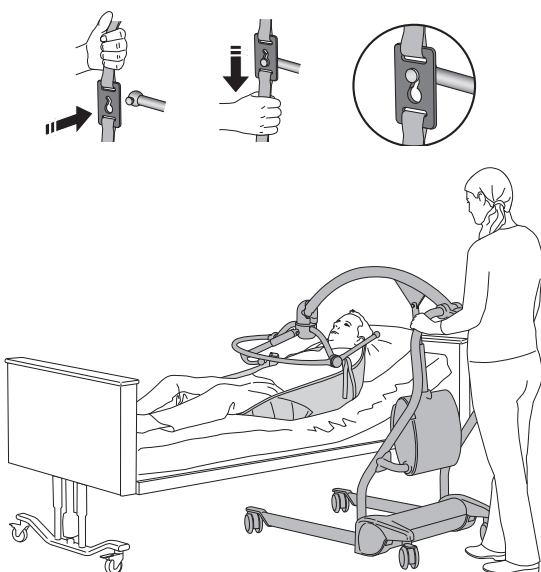

Continue with the steps on the next page.

Fig. 4

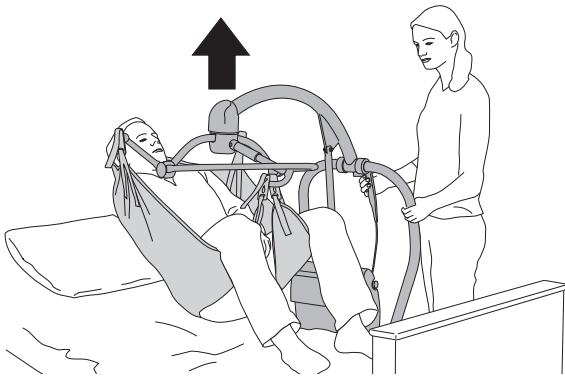

Fig. 5

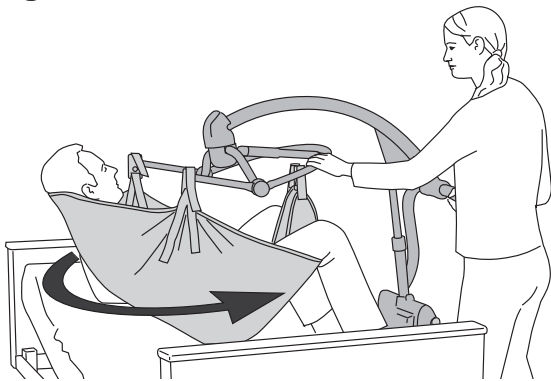
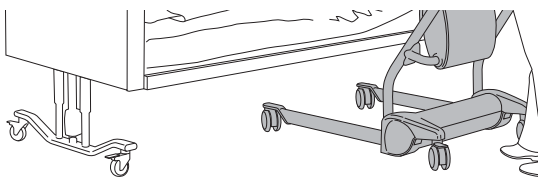

Fig. 6



Fig. 7



8 **WARNING**

To avoid injury to the resident, pay close attention when lowering or adjusting the spreader bar.

Lift the resident using the hand control. (See Fig. 4)

9 **NOTE**

When turning the resident pay close attention so as not to hit the resident's legs against the mast.

Turn the resident to face the caregiver. (See Fig. 5)

10 Adjust to a comfortable position for the resident, a little higher than a normal chair height. Make sure that her/his feet are safely above the floor. (See Fig. 6)

Return to Bed

When returning to a bed, make sure the lift is positioned perpendicular to the bed. (See Fig. 7)

To position the resident over the bed, use the lift handles, do NOT pull the sling. The resident suspended in sling should always remain in the centre of gravity.

Use the hand control to lower the resident.

Move into the desired position above the bed. Adjust the sling position and then lower the resident using the hand control.

WARNING

To avoid the resident from falling or caregiver from being injured, only detach the sling clips when the resident's body weight is fully supported by the bed or chair.

Move the *Maxi Twin Compact* lift away before removing the sling from under the resident.

Fig. 1

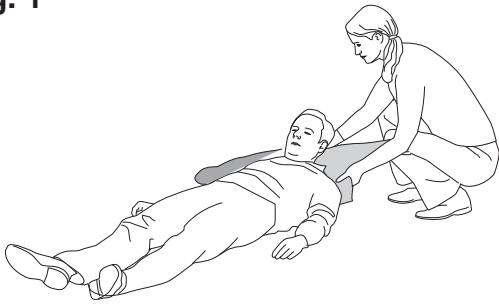

Fig. 2

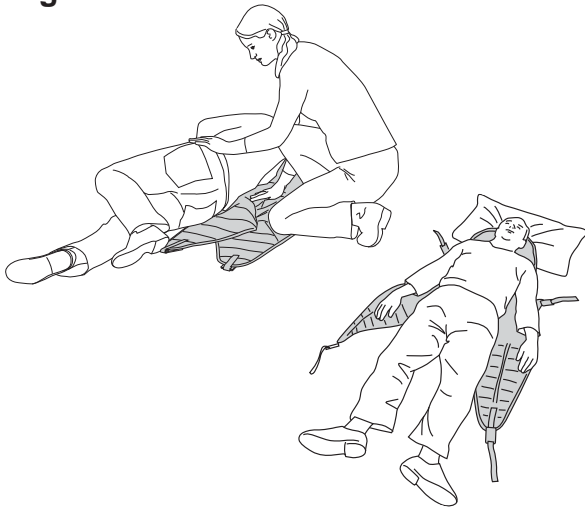

Fig. 3

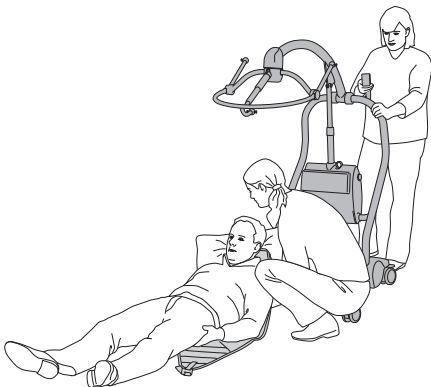
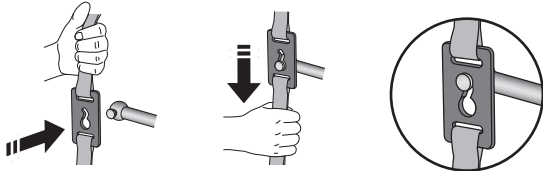

Fig. 4



To Lift from the Floor (9 Steps)

This procedure needs two caregivers.

- 1 Put a pillow under the resident's head and shoulders for comfort. (See Fig. 1)

2 **WARNING**

To avoid entrapment, make sure to keep the residents hair, arms and feet close to the body and use designated grab supports during any movement.

Put the sling around the resident by using the log roll method. See section *To Lift from a Chair (6 Steps)* on page 19 and *To Lift from a Bed (10 Steps)* on page 21. (See Fig. 2)

- 3 Approach the resident with the open part of the chassis. Open the chassis legs if necessary. Apply the brakes of the lift. (See Fig. 3)

- 4 Attach the shoulder clips. (See Fig. 4)

Continue with the steps on the next page.

Fig. 5

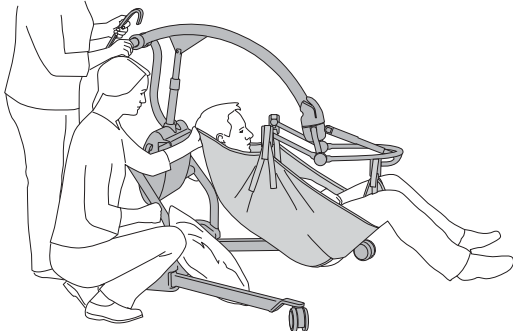

5 **WARNING**

To avoid injury, make sure there is a safe distance between the resident and the device. Pay particular attention to resident with uncontrollable movements.

Once connected, attach the leg clips. To ease the clip on process, push the appropriate button on the hand control to get the spreader bar in a closer position to the clips. This will have the effect of raising the resident's head and shoulders slightly. (See Fig. 5)

6 **WARNING**

To avoid the resident falling, make sure that sling clips or loops are securely attached before as well as during the lifting initiation.

Raise the resident from the floor in a semi-recumbent position. Supporting the head increases comfort and reassurance for the resident - maintain distance to the jib. Straighten out the leg sections of the sling out for added comfort. (See Fig. 5)

Fig. 6

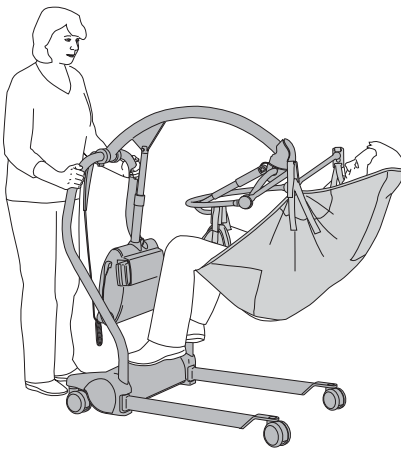

7 Turn the resident to face the caregiver. (See Fig. 6)

8 Adjust to a comfortable position for the resident, a little higher than a normal chair height. Make sure that her/his feet are a safe distance from floor. (See Fig. 6)

9 Release the brakes. (See Fig. 6)

Intentionally left blank

Home Care Use

For Distributors and Renters

When transporting the *Maxi Twin Compact* lift to the customer with a van:

- Make sure the lift is properly secured during transport.
- Avoid manoeuvring the lift in dirty ground when transporting it to and from the van.

When delivering the *Maxi Twin Compact* lift make sure that:

- You read this *IFU* together with the receiver (including relatives and caregivers).
- Show the features and intended usage described in the *IFU* with help of the real product.
- The user has understood the cleaning and disinfection instructions.
- Read all the warnings to the receiver.
- The environment fulfils all the requirements described in this *IFU*.

Cleaning and disinfection:

- Make sure that the cleaning and disinfection procedure described in this *IFU* always is carried out before the product reaches a new user.
- Make sure that the cleaning and disinfection procedure described in this *IFU* always is carried out before and after any type of service procedure.

Using Maxi Twin Compact Lift

Before using the *Maxi Twin Compact* lift in home environment make sure that: (See Fig. 1, 2 and 3)

WARNING

To avoid the device from tipping and the resident from falling, do not use the equipment on floor with recessed drains, holes or slopes exceeding a ratio of 1:50 (1.15°).

- All caregivers, including relatives, have read and understood the instructions in this *IFU*.
- All carpets and rugs in the environment are removed.
- All thresholds in the environment are removed.
- All stairs and edges have a fence and safety gate to prevent the lift from rolling down.
- There is room enough in the environment for use of the lift.

During Storage of the *Maxi Twin Compact* lift make sure that:

WARNING

To avoid strangulation, make sure to never leave children unattended near the equipment.

- No children can access the lift.
- No pets can come in contact with the lift.
- The storage environment fulfils the requirements specified under *Technical Specifications* in this *IFU*.

Fig. 1

Transfer between bed and wheelchair with a sling lift

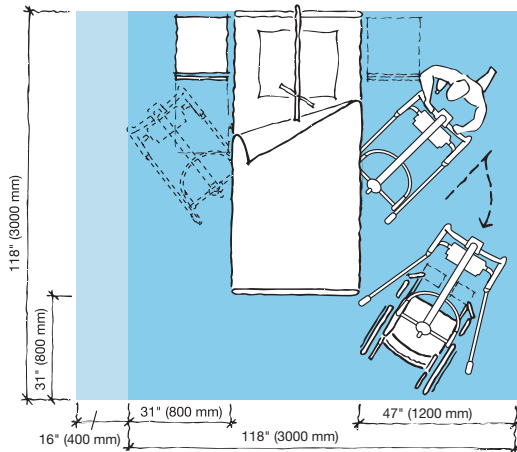

Fig. 2

Toileting with a sling lift

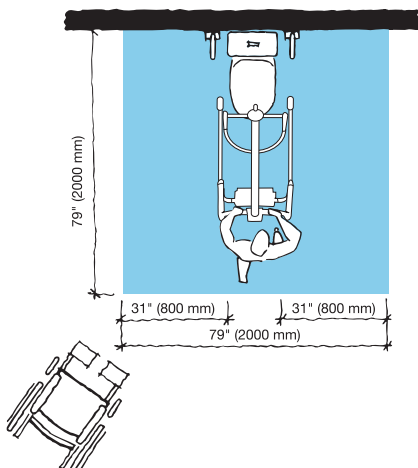
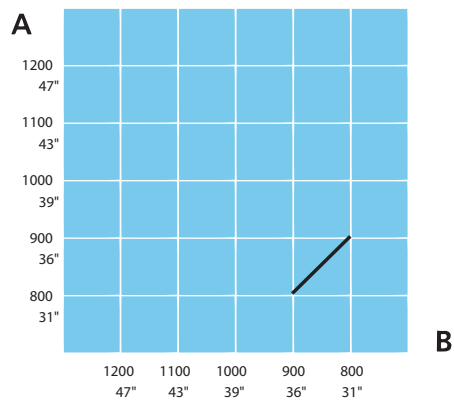

Fig. 3

Turning radii with a sling lift



Battery Instructions

WARNING

To avoid bodily injury, do NOT crush, puncture, open, dismantle or otherwise mechanically interfere with the battery.

- Should the battery casing crack and cause contents to come in contact with skin or clothing, rinse immediately with plenty of water.
- If contents come in contact with the eyes, rinse immediately with plenty of water and seek medical attention.

Inhalation of the contents can cause respiratory irritation. Provide fresh air and medical attention.

- Be careful not to drop the battery.
- Contact the appropriate local authority for advice when disposing of batteries.
- Check label on the battery.

Storage of Batteries

- The battery is delivered charged but we recommend you recharge the battery when received due to a slow self discharge.
- This battery will slowly self discharge when not used.
- A battery not in use should be stored in a temperature range of -0 °C (32 °F) to + 30 °C (86 °F).
- For maximum battery performance do not store the battery above 50 °C (122 °F).

Charging Intervals

- To prolong the life of the battery, charge it at regular intervals, i.e. every night.
- If the *Maxi Twin Compact* lift is used frequently, it is recommended to use two batteries, one in operation and one as a stand-by in the charger.
- It's recommended that a battery not in use is left in the charger. There is no risk of overcharging the battery.

Battery Service Life

Make sure to always have two well functional batteries, one to use and one in storage.

If using a freshly charged battery and the battery indicator starts to flash and sound after only a few activities are carried out, it is time to order a new battery.

Low Charge Warning

A buzzer sound will go off when the battery reaches a low charge. The battery should then be recharged as soon as possible.

Installation of Charger

See *NEA 8000 Battery Charger IFU*.

How to Change the Battery

See *NEA 8000 Battery Charger IFU*.

Intentionally left blank

Cleaning and Disinfecting Instructions

Only use ArjoHuntleigh Branded Disinfectant Cleansers (e.g. Arjo Clean™).

If you have any questions regarding disinfecting the *Maxi Twin Compact* lift, or wish to order disinfectant fluid, contact ArjoHuntleigh Customer Service.

Make sure to have the Material Safety Data Sheets (MSDS) available for the disinfectant being used.

WARNING



To avoid eye and skin damage, always use protective glasses and gloves. If contact occurs rinse with plenty of water. If eyes or skin becomes irritated, contact a physician. Always read the material safety data sheet of the disinfectant.

WARNING

To prevent cross-contamination, always follow the disinfection instructions in this *Instructions for Use*.

WARNING

To avoid eye or skin irritation, never disinfect in the presence of a resident.

CAUTION

To avoid damage on the equipment only use ArjoHuntleigh branded disinfectants.

CAUTION

Do not over spray areas of the product which could cause problems with electrical components and/or internal corrosion.

Accessories for Disinfecting the Maxi Twin Compact lift

- Protective gloves
- Protective glasses
- Spray bottle with disinfectant
- Spray bottle with water
- Cloth - wet and dry
- Disposable towels
- Soft bristled brush

Always Follow these 17 Steps for Proper Cleaning and Disinfection.

If an ArjoHuntleigh shower panels will be used, see respective *IFU*.

Removing visual residue (Step 1-3 of 17)

- 1 Remove parts such as slings, cushions and suspension straps (if applicable).
- 2 Clean the *Maxi Twin Compact* lift from visible residue using a cloth soaked in water alt. spray with water and wipe with a clean cloth. Start from top and move downwards.
- 3 Clean the removed parts from visible residue with a cloth soaked in water alt. spray with water and wipe with a clean cloth (if applicable).

Cleaning (Step 4-9 of 17)

- 4 Put on protective gloves and eye wear.
- 5 Spray disinfectant on the *Maxi Twin Compact* lift. Use a brush or a cloth if need for cleaning (to remove any deposits).
- 6 Use a new wet cloth to wipe off all traces of disinfectant on the *Maxi Twin Compact* lift or if more suitable by spraying water and wipe with a clean cloth.
- 7 Spray disinfectant on the removed parts (if applicable). Use a brush or a cloth soaked in disinfectant if needed for cleaning (to remove any deposits).
- 8 Use a new cloth soaked in water to remove all traces of disinfectant on the removed parts or spray water and wipe with a clean cloth (if applicable).
- 9 Repeat until all of the disinfectant has been removed.

Disinfection (Step 10-17 of 17)

- 10 Spray disinfectant on the *Maxi Twin Compact* lift.
- 11 Allow a disinfection time according to the instructions on the disinfectant bottle label.
- 12 Spray disinfectant on the removed parts.
- 13 Allow a disinfection time according to the instructions on the disinfectant bottle label.
- 14 Use a new wet cloth to wipe off all traces of disinfectant on the equipment or if more suitable by spraying water and wipe with a clean cloth.

- 15 Use a new wet cloth to wipe off all traces of disinfectant on the removed parts or if more suitable by spraying water and wipe with a clean cloth.
- 16 If disinfectant cannot be removed, spray water on the affected part and wipe off with disposable towels. Repeat until all of the disinfectant has been removed.
- 17 Let all parts dry.

Care and Preventative Maintenance

The *Maxi Twin Compact* lift is subject to wear and tear, and the following actions must be performed when specified to make sure that the product remains within its original manufacturing specification.

WARNING

To avoid malfunction resulting in injury, make sure to conduct regular inspections and follow the recommended maintenance schedule. In some cases due to heavy use of the product and exposure to aggressive environment more frequent inspections should be carried out. Local regulations and standards may be more stringent than the recommended maintenance schedule.

NOTE

Product cannot be maintained and serviced while in use with the patient

PREVENTIVE MAINTENANCE SCHEDULE: Maxi Twin Compact lift

CAREGIVER OBLIGATIONS Action/Check	Every DAY	Every WEEK
Disinfect	X	
Visually check the slings	X	
Replace with charged battery	X	
Visually check all exposed parts		X
Visually check mechanical attachments		X
Check hand control and cable		X
Check and clean castors		X
Check the brake function		X
Visually check battery charger and battery		X
Perform functionality test		X

WARNING

To avoid injury to both resident and caregiver, never modify the equipment or use incompatible parts.

Caregiver Obligations

Caregiver obligations shall be carried out by personnel with sufficient the *Maxi Twin Compact* lift knowledge and by following the instructions in this *IFU*.

Fig. 1

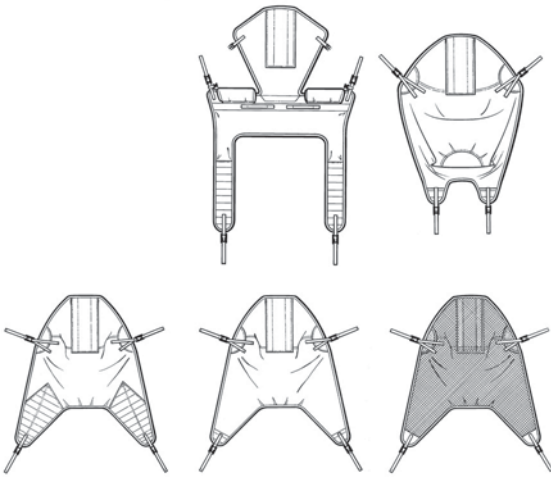

Every day

- **Disinfect:**
The *Maxi Twin Compact* lift has to be disinfected immediately after use. ArjoHuntleigh cleaning agents should be used in **recommended concentrations**. See section *Cleaning and Disinfecting Instructions* on page 30.
- **Visually check the slings:**
Check for fraying, holes, cuts, loose stitching and damaged plastic clips. If the sling is found damaged in any way, take out of use immediately and replace the sling. **(See Fig. 1)**
- **Use a fully charged battery** at the beginning of the day.

Every week

- **Visually check all exposed parts:**
Visually check all exposed parts, especially where personal contact is made by either the resident or caregiver. Make sure no cracks or sharp edges have developed that could cause the resident or user injury or that has become unhygienic. Replace damaged parts.
- **Visually check that:**
the soft cover **(A)** is in place and without damage. Visually check the attachment for the actuators **(B)** and the attachment between jib and spreader bar **(C)**. Visually check the sling attachment knobs **(D)**, for damage. Check the spreader bar pivot for any suspect damage, for instance, such as protruding plastic **(E)**. **(See Fig. 2)**

Fig. 2

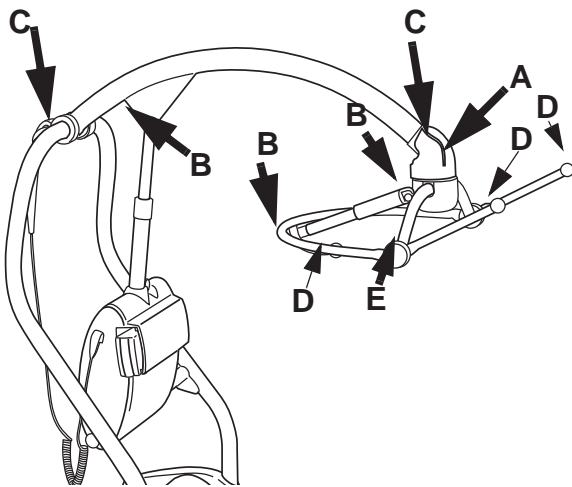

Continue with the steps on the next page.

Fig. 3

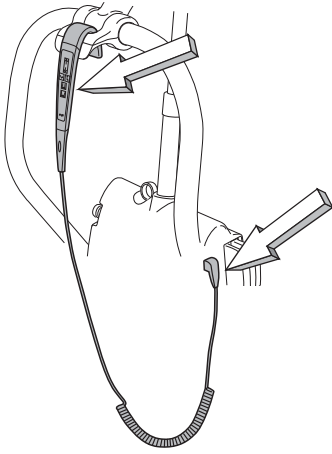

- **Check hand control and cable:**
Visually check the condition of the hand control and its cable. If found cut, damaged or exposed wiring, replace it. (See Fig. 3)

Fig. 4

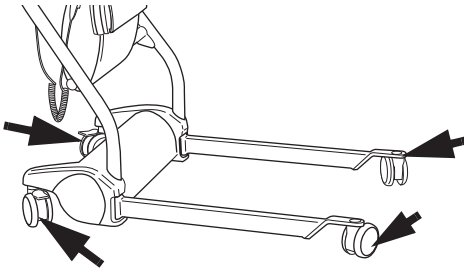

- **Check that the castors are properly fixed and that they roll and swivel freely.**
Clean with water. (the function can be affected by soap, hair, dust and chemicals from floor cleaning). Check the brake function. (See Fig. 4)

Fig. 5

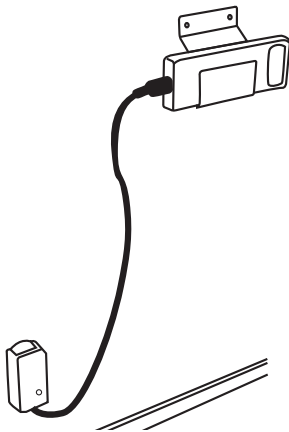

- **Visually check the condition of the battery charger, its cable and the batteries.**
Remove and replace immediately if damaged. (See Fig. 5)
- **Carry out a full functionality test and by lifting up and down.**
Test the movement of the spreader bar and the open/close function of the legs. All functions should work as expected without divergences.

Yearly

- The *Maxi Twin Compact* lift has to be serviced according to the table *QUALIFIED PERSONNEL Action/Check on page 35*.

WARNING

To avoid injury and/or unsafe product, the maintenance activities must be carried out at the correct frequency by qualified personnel using correct tools, parts and knowledge of procedure. Qualified personnel must have documented training in maintenance of this device.

QUALIFIED PERSONNEL Action/Check	Every YEAR
Check that the latest upgrades have been implemented	X
Check all vital parts for corrosion and damage	X
Check mechanical attachments	X
Perform a safe working load test (local requirements)	X
Check all actuators for function and range	X
Check movable parts of the spreader bar	X
Check function of emergency lowering	X
Check function of emergency stop	X
Check the safety stop function	X
Check/replace castors	X
Check battery	X
Perform full feature functionality test	X

NOTE

All Caregiver Obligations are to be checked when performing the Qualified Personnel Service.

Troubleshooting

PROBLEM	ACTION
The lift raises or lowers after the hand control buttons are released.	Activate the red emergency stop button and pull the battery out, remove the resident from the lift and contact qualified personnel.
The lift does not raise or descend when the hand control buttons are pressed.	<ol style="list-style-type: none"> 1 Make sure that the battery is fully connected in the battery compartment. 2 Make sure that the hand control connection plug is properly connected to the socket. 3 Make sure that the battery is charged. <div style="border: 1px solid black; padding: 5px; margin: 10px 0;"> <p>WARNING To avoid injury, make sure that the resident is not left unattended at any time.</p> </div> <ol style="list-style-type: none"> 4 Make sure the emergency stop button is inactivated by turning the red knob clockwise. 5 Use the emergency lowering to lower the resident. Pull the purple ring up to operate. When the ring is released the movement will stop - remove the resident from the lift and contact qualified personnel.
The lift is hard to manoeuvre during transfer.	<ol style="list-style-type: none"> 1 Make sure all brakes are released. 2 Make sure all castors roll and swivel freely - if not, remove the resident from the lift and contact qualified personnel.
The lift is making abnormal sounds during lifting or transfer.	Remove the resident from the lift and contact qualified personnel.
It is only possible to lower the lift.	The lifting device of this equipment is equipped with a safety nut. If the safety nut will be activated it will only be possible to lower the equipment into a safe position. In case of this scenario stop using the equipment and contact qualified personnel for repair of the equipment.

ALARMS	ACTION
A buzzing is heard as the lift is raised.	<p>The battery needs charging - complete the transfer operation in progress and change to a fully charged battery.</p> <div style="border: 1px solid black; padding: 5px; margin: 10px 0;"> <p>WARNING To avoid injury, make sure that the resident is not left unattended at any time.</p> </div>
The lift stops its motion as the lift is lowered/raised or when the spreader bar is moved to a sitting position.	The lift has been lowered/raised against a fixed object. Carefully raise/lower and reposition the lift.
Only a few activities are carried out before the battery indicator will flash and sound.	Replace the battery with a fully charged one. If using a freshly charged battery and the battery indicator starts to flash and sound after only a few activities are carried out, it is time to order a new battery.

Intentionally left blank

Technical Specifications

Maxi Twin Compact lift	
Safe working load (SWL) (Max patient weight regardless of spreader bar)	160 kg (350 lbs.)
Colour	Grey
Medical equipment	type BF 
Sound level	49 dB (A)
Mode of operation	ED maximum 10%; Maximum 2 minutes ON; Minimum 18 minutes OFF
Operating forces of controls	2.7 N
Degree of fire protection	In accordance with standard EN 60601-1.
Pollution degree	2

Component weights	
<i>Maxi Twin Compact</i> lift (no scale, hanger bar or battery)	46.5 kg (101 lbs.)
Maximum total weight of lift (Lift and Patient)	208 kg (453 lbs.)
Battery Pack	1.3 kg (2.9 lbs.)

Allowed combinations	
The <i>Maxi Twin Compact</i> lift can be used with the following ArjoHuntleigh products: No other combinations are allowed.	Hanger Bar, Power DPS Medium Sizes: S/M/L/XL

Operation, transport and storage	
Ambient temperature range	Operation +10 °C to +40 °C (+ 50 °F to 104 °F) Transport and Storage -20 °C to +70 °C (-4 °F to +158 °F)
Relative humidity range	30% - 75% Operation 10% - 80% Transport and Storage
Atmospheric pressure range	800 - 1060 hPa Operation 500 - 1100 hPa Transport and Storage

Electricity	
Battery	ArjoHuntleigh NEA 0100
Battery Charger	Type no: NEA 8000
Equipment voltage	24 V DC
Protection class	IP 24 IP: Ingress Protection 2: Protection against insertion of fingers or similar objects. 4: Water splashing against the product from any direction does not effect safety or essential performance
Hand control Protection class	IP X7 IP: Ingress Protection X: The protection against contact and ingress of objects is not specified for this product. 7: Immersion up to 1 m of the product does not effect safety or essential performance
Fuse	F1 F10AL 250 V F2 T4AL 250V

Recycling	
The device should be recycled according to national regulations	
Battery	NiMH. Recyclable. Not for disposal. Environment danger
Package	Wood and corrugated cardboard, recyclable
The Lift and Charger	Electric, steel and plastic parts shall be separated and recycled according to WEEE.

Disposal of Maxi Twin Compact lift	
Lift	The device is marked with the WEEE symbol to indicate that it is electronic equipment covered by the Directive 2012/19/EU (WEEE) on waste electrical and electronic equipment. In European countries the crossed out wheeled-bin WEEE symbol reminds you that all the electrical and electronic products, batteries and accumulators must be taken to separate collection at end of their working life. This requirement applies in the European Union. Do not dispose these products as unsorted municipal waste. You can return your device and accessories to ArjoHuntleigh or you can contact your local authorities for advice on disposal.

Dimensions

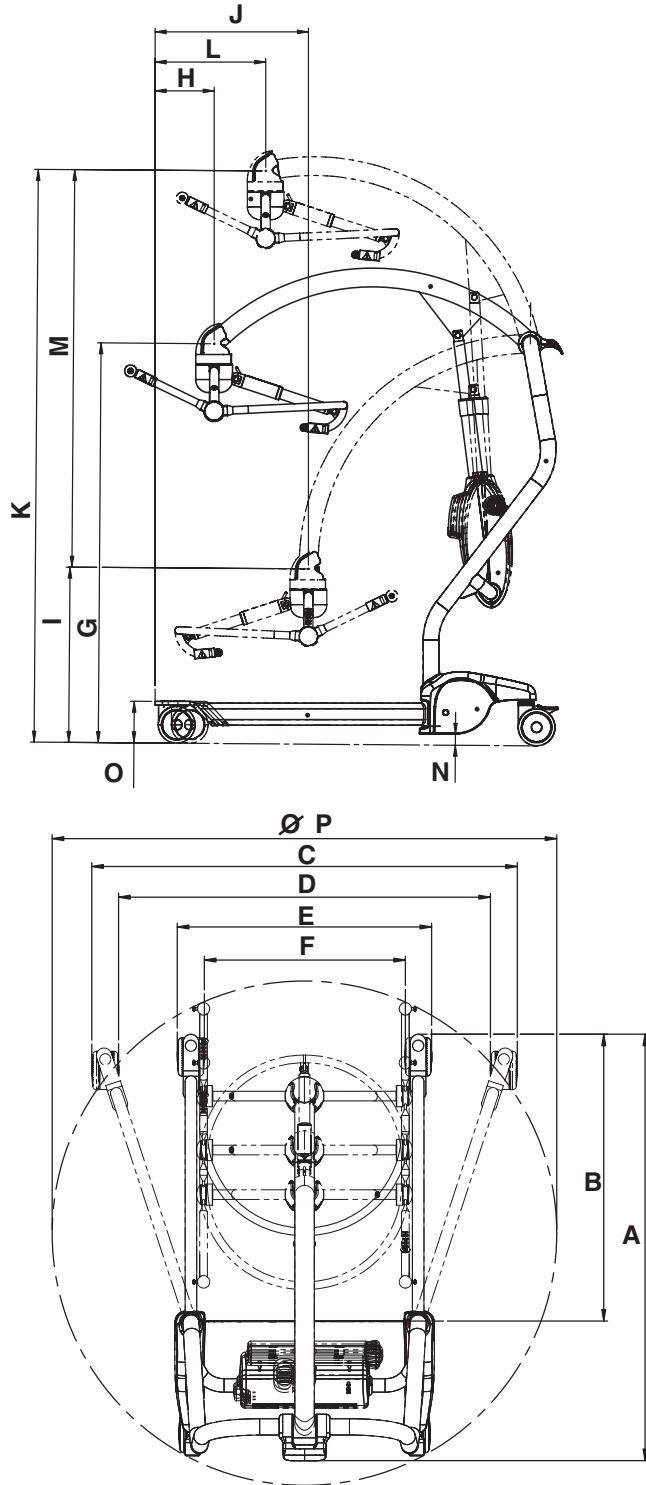









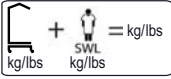

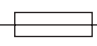
Reference	Note	Dimension mm	Dimension inch
A	Max. External Length	1110	43 5/8
B	Max. Internal Length	745	29 3/8
C	Max. External Width	1105	43 1/2
D	Max. Internal Width	965	38
E	Min. External Width	660	26
F	Min. Internal Width	520	20 1/2
G	Height of C.S.P at Max Hoisting Reach	1090	42 3/4
H	Max. Hoisting Reach	860	33 7/8
I	Min. Height of C.S.P	480	18 3/4
J	Hoisting Reach at Min. Height of C.S.P	600	23 5/8
K	Max Height of C.S.P	1560	61 1/4
L	Hoisting Reach at Max. Height of C.S.P	720	28 1/2
M	Hoisting Range	1080	42 1/2
N	Min. Clearance	30	1 1/8
O	Max. Height	115	4 1/2
P	Turning Diameter	1310	5 1/8

Intentionally left blank

Labels on Maxi Twin Compact Lift

On the data label you will find the following information:

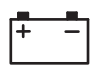
SWL	Safe Working Load
	Total mass of equipment including its safe working load.
	Lifting stroke
24V DC	Supply voltage
MAX: 200 VA	Maximum power
	Fuse F1 – F10AL 250V Fuse F2 T4AL 250V
IP 24	Degree of protection (i.e. the product is protected against insertion of fingers and splashing water)
	Type BF Applied part: protection against electrical shock in accordance with EN/IEC 60601-1.
2 min on/ 18 min off	Mode of operation for Hi/Lo function: Maximum 2 minutes ON; Minimum 18 minutes OFF
NEA0100-083 24Vdc 2.5 Ah	Product no and data of the battery
	Read the <i>IFU</i> before use
	Separate electrical and electronic components for recycling in accordance with the European Directive 2012/19/EU (WEEE)
	CE marking in accordance with the Medical Devices Directive 93/42/EEC.
	TÜV marking. The lift has been safety tested in accordance with the Approvals and List of Standards.

	A battery is the power source of this equipment.
	Environmental danger. Not for disposal
	Recyclable

Identification Label

The identification label states the type of equipment and serial number (see figure).

Sling Range Label

Fitted to the spreader bar frame for quick colour reference to size and safe working load.

Attention Label

On the spreader bar frame to indicate “not for use in bath or shower”.

Clips Instructions Labels

Labels placed by the knobs where the clips should be connected and on the spreader bar actuator.

Battery Indicator Label

Positioned on the battery housing to indicate when the battery needs charging.

Emergency Lowering Label

Positioned near the control of emergency lowering.

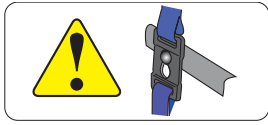
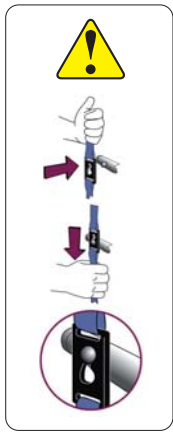

Clips instructions labels



Attention label

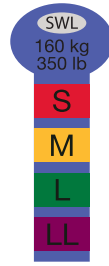

Sling range label



Emergency lowering label



Battery indicator label

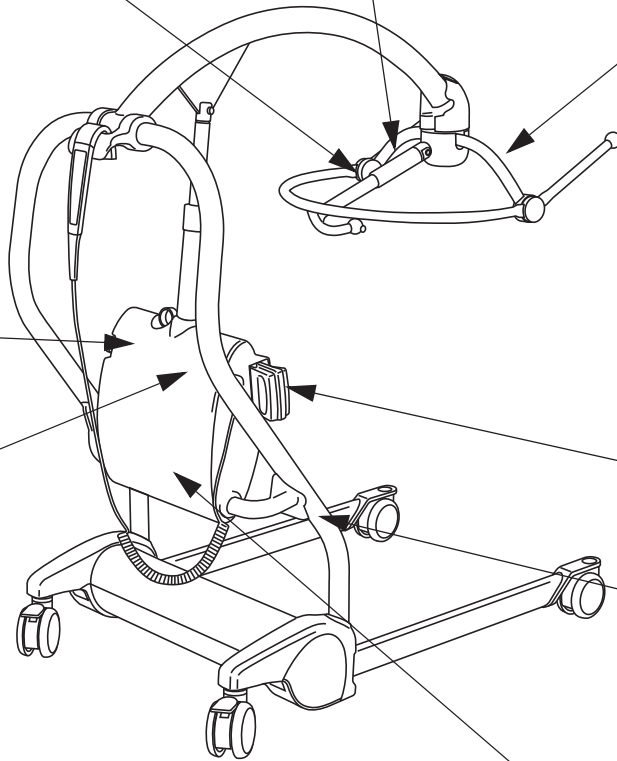

Battery Label

Data label

Identification Label

List of Standards and Certificates

CERTIFICATE	STANDARDS
EN/IEC 60601-1:2005 AMD1:2012	Medical Electrical Equipment - Part 1: General Requirements for Basic Safety and Essential Performance
ANSI/AAMI ES60601-1 (2005) AMD 1 (2012)	Medical Electrical Equipment - Part 1: General Requirements for Basic Safety and Essential Performance
CAN/CSA-C22.2 No. 60601-1:14	Medical Electrical Equipment - Part 1: General Requirements for Basic Safety and Essential Performance
ISO 10535:2006	Hoists for the transfer of disabled persons -- Requirements and test methods
EN/IEC 60601-1-11:2015	Requirements for medical electrical equipment and medical electrical systems used in the home healthcare environment

Electromagnetic Compatibility

Medical electrical equipment needs special precautions regarding EMC (Electromagnetic compatibility) and needs to be used according to the EMC information below.

The *Maxi Twin Compact* lift is intended for use in the electromagnetic environment specified below. The customer or the user of the *Maxi Twin Compact* lift should assure that it is used in such an environment.

WARNING

Stacking or placing other electrical equipment next to this device is not recommended, it can interfere with the equipment's operation and safety. Portable and mobile radio-frequency (RF) communications equipment can interfere with this equipment operation and safety.

WARNING

The equipment may cause radio interference or may disrupt the operation of nearby equipment. It may be necessary to take action, such as reorienting, relocating the equipment or shielding the location.

Guidance and manufacturer's declaration - electromagnetic emissions

Emissions test	Compliance	Electromagnetic environment - guidance
RF emissions CISPR 11	Group 1	The <i>Maxi Twin Compact</i> lift uses RF energy only for its internal function. Therefore, its RF emissions are very low and are not likely to cause any interference in nearby electronic equipment.
RF emissions CISPR 11	Class B	The <i>Maxi Twin Compact</i> lift is suitable for use in all establishments, those directly connected to the public low-voltage power supply network that supplies buildings used for domestic purposes.

Guidance and manufacturer's declaration - electromagnetic immunity			
Emissions test	IEC 60601 test level	Compliance	Electromagnetic environment - guidance
Electrostatic discharge (ESD) IEC 61000-4-2	6 kV contact 8 kV air	6 kV contact 8 kV air	Floors should be wood, concrete or ceramic tile. If floors are covered with synthetic material, the relative humidity should be at least 30%.
Radiated RF IEC 61000-4-3	3 Vrms 80 MHz to 2.5 GHz	10 Vrms 80 MHz to 2.5 GHz	<p>Portable and mobile RF communications equipment should be used no closer to any part of the <i>Maxi Twin Compact</i> lift, including cables, than 1 meter if the transmitters output power rating exceeds 1 W.</p> <p>Field strengths from fixed RF transmitters, as determined by an electromagnetic site survey, A) should be less than the compliance level in each frequency range. b)</p> <p>Interference may occur in the vicinity of equipment marked with the following symbol:</p> 
<p>Field strengths from fixed transmitters, such as base stations for radio (cellular/cordless) telephones and land mobile radios, amateur radio, AM and FM radio broadcast and TV broadcast cannot be predicted theoretically with accuracy. To assess the electromagnetic environment due to fixed RF transmitters, an electromagnetic site survey should be considered. If the measured field strength in the location in which the <i>Maxi Twin Compact</i> lift is used exceeds the applicable RF compliance level above, the <i>Maxi Twin Compact</i> lift should be observed to verify normal operation. If abnormal performance is observed, additional measures may be necessary.</p> <p>b) Over the frequency range 150 kHz to 80 MHz, field strengths should be less than 1 V/m.</p>			

Recommended separation distances between portable and mobile RF communications equipment and the *Maxi Twin Compact* lift.

The *Maxi Twin Compact* lift is intended for use in an electromagnetic environment in which radiated RF disturbances are controlled.

The customer or the user of the *Maxi Twin Compact* lift can help prevent electromagnetic interference by maintaining a minimum distance between portable and mobile RF communications equipment (transmitters) and the *Maxi Twin Compact* lift by maintaining a distance of not less than 1 meter to any part of the *Maxi Twin Compact* lift, including cables, if the transmitters output power rating exceeds 1 W.

Parts and Accessories

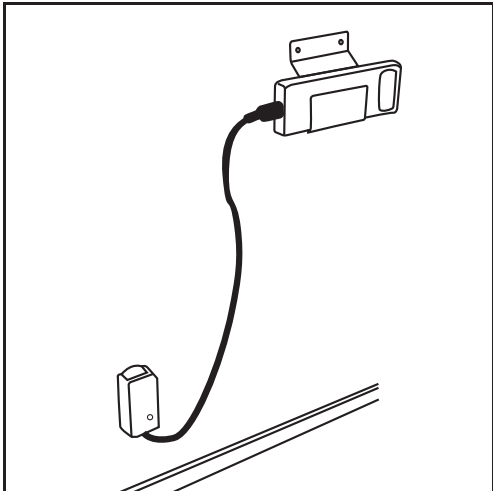

Battery and charger

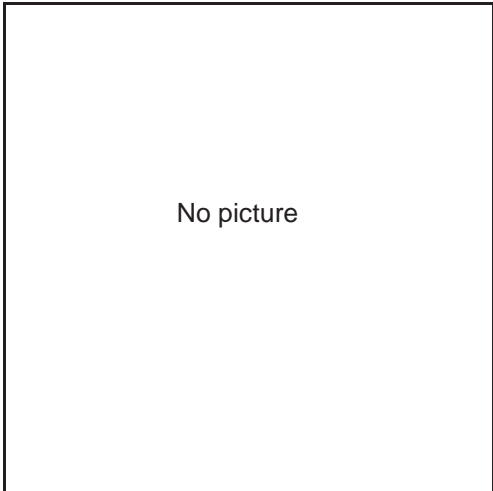

Sling
Contact your local representative.

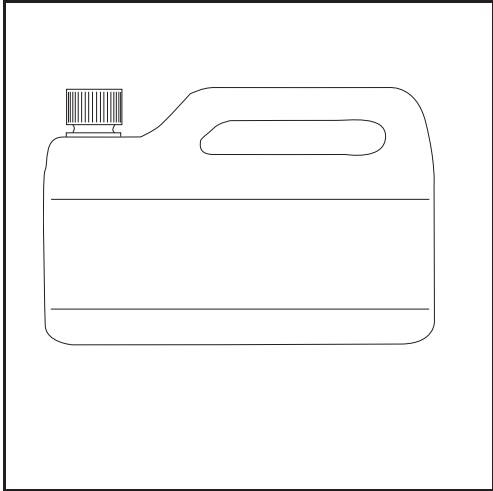

Disinfectant

AUSTRALIA

ArjoHuntleigh Pty Ltd
78, Forsyth Street
O'Connor
AU-6163 Western Australia
Tel: +61 89337 4111
Free: +1 800 072 040
Fax: + 61 89337 9077

BELGIQUE / BELGIË

ArjoHuntleigh NV/SA
Evenbroekveld 16
BE-9420 ERPE-MERE
Tél/Tel: +32 (0) 53 60 73 80
Fax: +32 (0) 53 60 73 81
E-mail: info.belgium@arjohuntleigh.be

BRASIL

Maquet do Brasil
Equipamentos Médicos Ltda
Rua Tenente Alberto Spicciati, 200
Barra Funda, 01140-130
SÃO PAULO, SP - BRASIL
Fone: +55 (11) 2608-7400
Fax: +55 (11) 2608-7410

CANADA

ArjoHuntleigh
90 Matheson Boulevard West
Suite 300
CA-MISSISSAUGA, ON, L5R 3R3
Tel/Tél: +1 905 238 7880
Free: +1 800 665 4831 Institutional
Free: +1 800 868 0441 Home Care
Fax: +1 905 238 7881
E-mail: info.canada@arjohuntleigh.com

ČESKÁ REPUBLIKA

ArjoHuntleigh s.r.o.
Hlinky 118
CZ-603 00 BRNO
Tel: +420 549 254 252
Fax: +420 541 213 550

DANMARK

ArjoHuntleigh A/S
Vassingerødvej 52
DK-3540 LYNGE
Tel: +45 49 13 84 86
Fax: +45 49 13 84 87
E-mail: dk_kundeservice@arjohuntleigh.com

DEUTSCHLAND

ArjoHuntleigh GmbH
Peter-Sander-Strasse 10
DE-55252 MAINZ-KASTEL
Tel: +49 (0) 6134 186 0
Fax: +49 (0) 6134 186 160
E-mail: info-de@arjohuntleigh.com

ESPAÑA

ArjoHuntleigh Ibérica S.L.
Ctra. de Rubí, 88 1ª planta - A1
08173 Sant Cugat del Vallés
ES- BARCELONA 08173
Tel: +34 93 583 11 20
Fax: +34 93 583 11 22
E-mail: info.es@arjohuntleigh.com

FRANCE

ArjoHuntleigh SAS
2 Avenue Alcide de Gasperi
CS 70133
FR-59436 RONCQ CEDEX
Tél: +33 (0) 3 20 28 13 13
Fax: +33 (0) 3 20 28 13 14
E-mail: info.france@arjohuntleigh.com

HONG KONG

Getinge Group Hong Kong Ltd
1510-17, 15/F, Tower 2
Kowloon Commerce Centre
51 Kwai Cheong Road
Kwai Chung
HONG KONG
Tel: +852 2207 6363
Fax: +852 2207 6368

ITALIA

ArjoHuntleigh S.p.A.
Via Giacomo Peroni 400-402
IT-00131 ROMA
Tel: +39 (0) 6 87426211
Fax: +39 (0) 6 87426222
E-mail: Italy.promo@arjohuntleigh.com

MIDDLE EAST

Getinge Group Middle East
Office G005 - Nucleotide Complex,
Dubai Biotechnology & Research Park,
P.O.Box 214742, Dubai,
United Arab Emirates
Tel: +971 (0)4 447 0942
E-mail: Info.ME@getinge.com

NEDERLAND

ArjoHuntleigh Nederland BV
Biezenwei 21
4004 MB TIEL
Postbus 6116
4000 HC TIEL
Tel: +31 (0) 344 64 08 00
Fax: +31 (0) 344 64 08 85
E-mail: info.nl@arjohuntleigh.com

NEW ZEALAND

ArjoHuntleigh Ltd
41 Vestey Drive
Mount Wellington
NZ-AUCKLAND 1060
Tel: +64 (0) 9 573 5344
Free Call: 0800 000 151
Fax: +64 (0) 9 573 5384
E-mail: nz.info@ArjoHuntleigh.com

NORGE

ArjoHuntleigh Norway AS
Olaf Helsets vei 5
N-0694 OSLO
Tel: +47 22 08 00 50
Faks: +47 22 08 00 51
E-mail: no.kundeservice@arjohuntleigh.com

ÖSTERREICH

ArjoHuntleigh GmbH
Dörrstrasse 85
AT-6020 INNSBRUCK
Tel: +43 (0) 512 204 160 0
Fax: +43 (0) 512 204 160 75

POLSKA

ArjoHuntleigh Polska Sp. z o.o.
ul. Ks Piotra Wawrzyniaka 2
PL-62-052 KOMORNIKI (Poznań)
Tel: +48 61 662 15 50
Fax: +48 61 662 15 90
E-mail: arjo@arjohuntleigh.com

PORTUGAL

ArjoHuntleigh em Portugal
MAQUET Portugal, Lda. (Distribuidor Exclusivo)
Rua Poeta Bocage n.º 2 - 2G
PT-1600-233 Lisboa
Tel: +351 214 189 815
Fax: +351 214 177 413
E-mail: Portugal@arjohuntleigh.com

SUISSE / SCHWEIZ

ArjoHuntleigh AG
Fabrikstrasse 8
Postfach
CH-4614 HÄGENDORF
Tél/Tel: +41 (0) 61 337 97 77
Fax: +41 (0) 61 311 97 42

SUOMI

ArjoHuntleigh Finland
c/o Getinge Finland Oy
Riihitontuntie 7 C
02200 Espoo
Finland
Puh: +358 9 6824 1260
E-mail: Asiakaspalvelu.finland@arjohuntleigh.com

SVERIGE

Arjo Sverige AB
Hans Michelsensgatan 10
SE-211 20 MALMÖ
Tel: +46 (0) 10 494 7760
Fax: +46 (0) 10 494 7761
E-mail: kundservice@arjohuntleigh.com

UNITED KINGDOM

ArjoHuntleigh UK
ArjoHuntleigh House
Houghton Hall Park
Houghton Regis
UK-DUNSTABLE LU5 5XF
Tel: +44 (0) 1582 745 700
Fax: +44 (0) 1582 745 745
E-mail: sales.admin@arjohuntleigh.com

USA

ArjoHuntleigh Inc.
2349 W Lake Street Suite 250
US-Addison, IL 60101
Tel: +1 630 307 2756
Free: +1 800 323 1245 Institutional
Free: +1 800 868 0441 Home Care
Fax: +1 630 307 6195
E-mail: us.info@arjohuntleigh.com

ゲティンゲグループ・ジャパン株式会社
〒140-0002
東京都品川区東品川 2-2-8
スフィアタワー天王洲 23F
電話 : 03-6863-6642
Fax : 03-5463-6856

ARJOHUNTLEIGH
GETINGE GROUP



ArjoHuntleigh AB
Hans Michelsensgatan 10
211 20 Malmö, Sweden
www.arjohuntleigh.com

CE
0086

ArjoHuntleigh is a world-leading provider of integrated products and solutions that improve the lives of patients and residents with reduced mobility. We help healthcare facilities deliver wellness and effective everyday care, early mobilisation, safe patient handling, venous thromboembolism prevention, pressure injury prevention, hygiene routines, bariatric care and diagnostics. With extensive knowledge and experience, we strive to improve efficiency and ensure a safer and dignified environment for caregivers and their patients.
